

# Ringkabelschuhe, unisoliert

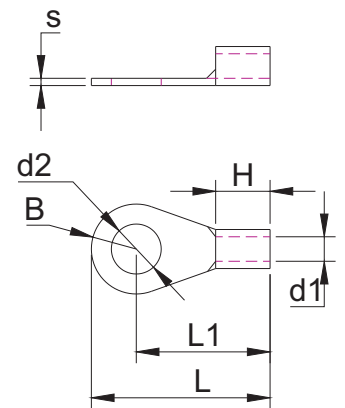

- Kontaktmaterial Elektrolyt-Kupfer
- Oberfläche galvanisch verzinkt
- Abmessungen nach DIN 46234 oder ähnlich
- Temperaturbereich -60 bis +105°C
- maximale Betriebsspannung 600V

Weitere Querschnitte und Anschlussdurchmesser auf Anfrage

| Artikelnummer                               | L    | L1   | H   | d1  | d2   | für Bolzen | B    | s   | VE   | €/ 100 |
|---|------|------|-----|-----|------|------------|------|-----|------|--------|
| Leiterquerschnitt 0,5 - 1,5 mm <sup>2</sup> |      |      |     |     |      |            |      |     |      |        |
| Q 1-2,5                                     | 14,6 | 11,0 | 5,0 | 1,6 | 2,7  | M2,5       | 6,0  | 0,8 | 1000 | 2,96   |
| Q 1-3                                       | 14,6 | 11,0 | 5,0 | 1,6 | 3,2  | M3         | 6,0  | 0,8 | 1000 | 2,42   |
| Q 1-3,5                                     | 14,6 | 11,0 | 5,0 | 1,6 | 3,7  | M3,5       | 6,0  | 0,8 | 1000 | 2,56   |
| Q 1-4                                       | 16,0 | 12,0 | 5,0 | 1,6 | 4,2  | M4         | 8,0  | 0,8 | 1000 | 2,69   |
| Q 1-5                                       | 17,3 | 13,0 | 5,0 | 1,6 | 5,3  | M5         | 10,0 | 0,8 | 1000 | 2,82   |
| Q 1-6                                       | 17,3 | 13,0 | 5,0 | 1,6 | 6,5  | M6         | 10,0 | 0,8 | 1000 | 3,24   |
| Leiterquerschnitt 1,5 - 2,5 mm <sup>2</sup> |      |      |     |     |      |            |      |     |      |        |
| Q 2,5-3                                     | 14,6 | 11,0 | 5,0 | 2,3 | 3,2  | M3         | 4,8  | 0,8 | 1000 | 3,00   |
| Q 2,5-3,5                                   | 14,6 | 11,0 | 5,0 | 2,3 | 3,7  | M3,5       | 5,6  | 0,8 | 1000 | 3,12   |
| Q 2,5-4                                     | 16,0 | 12,0 | 5,0 | 2,3 | 4,2  | M4         | 6,3  | 0,8 | 1000 | 3,24   |
| Q 2,5-5                                     | 18,6 | 14,0 | 5,0 | 2,3 | 5,3  | M5         | 8,0  | 0,8 | 1000 | 3,70   |
| Q 2,5-6                                     | 21,3 | 16,0 | 5,0 | 2,3 | 6,5  | M6         | 9,8  | 0,8 | 1000 | 4,65   |
| Q 2,5-8                                     | 22,6 | 17,0 | 5,0 | 2,3 | 8,4  | M8         | 12,6 | 0,8 | 1000 | 5,01   |
| Leiterquerschnitt 4 - 6 mm <sup>2</sup>     |      |      |     |     |      |            |      |     |      |        |
| Q 6-4                                       | 18,6 | 14,0 | 6,0 | 3,6 | 4,3  | M4         | 8,0  | 1,0 | 500  | 5,18   |
| Q 6-5                                       | 20,0 | 15,0 | 6,0 | 3,6 | 5,3  | M5         | 10,0 | 1,0 | 500  | 6,42   |
| Q 6-6                                       | 21,3 | 16,0 | 6,0 | 3,6 | 6,5  | M6         | 11,0 | 1,0 | 500  | 6,72   |
| Q 6-8                                       | 25,3 | 19,0 | 6,0 | 3,6 | 8,4  | M8         | 14,0 | 1,0 | 500  | 7,68   |
| Q 6-10                                      | 27,9 | 21,0 | 6,0 | 3,6 | 10,5 | M10        | 18,0 | 1,0 | 500  | 8,56   |
| Leiterquerschnitt 10 mm <sup>2</sup>        |      |      |     |     |      |            |      |     |      |        |
| Q 10-4                                      | 18,6 | 14,0 | 8,0 | 4,5 | 4,3  | M4         | 8,0  | 1,1 | 100  | 5,27   |
| Q 10-5                                      | 21,3 | 16,0 | 8,0 | 4,5 | 5,3  | M5         | 10,0 | 1,1 | 100  | 7,40   |
| Q 10-6                                      | 22,6 | 17,0 | 8,0 | 4,5 | 6,5  | M6         | 11,0 | 1,1 | 100  | 8,64   |
| Q 10-8                                      | 26,6 | 20,0 | 8,0 | 4,5 | 8,4  | M8         | 14,0 | 1,1 | 100  | 9,98   |
| Q 10-10                                     | 27,9 | 21,0 | 8,0 | 4,5 | 10,5 | M10        | 18,0 | 1,1 | 100  | 10,34  |
| Q 10-12                                     | 30,6 | 23,0 | 8,0 | 4,5 | 13,0 | M12        | 22,0 | 1,1 | 100  | 12,57  |

Maßangaben ohne Gewähr, Richtwerte, Abweichungen möglich

# Ringkabelschuhe, unisoliert

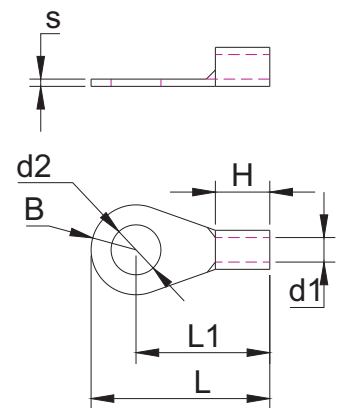

- Kontaktmaterial Elektrolyt-Kupfer
- Oberfläche galvanisch verzinkt
- Abmessungen nach DIN 46234 oder ähnlich
- Temperaturbereich -60 bis +105°C
- maximale Betriebsspannung 600V

Weitere Querschnitte und Anschlussdurchmesser auf Anfrage

| Artikelnummer                        | L    | L1   | H    | d1  | d2   | für Bolzen | B    | s   | VE  | €/ 100 |
|--------------------------------------|------|------|------|-----|------|------------|------|-----|-----|--------|
| Leiterquerschnitt 16 mm <sup>2</sup> |      |      |      |     |      |            |      |     |     |        |
| Q 16-5                               | 26,6 | 20,0 | 10,0 | 5,8 | 5,3  | M5         | 11,0 | 1,2 | 100 | 11,70  |
| Q 16-6                               | 26,6 | 20,0 | 10,0 | 5,8 | 6,5  | M6         | 11,0 | 1,2 | 100 | 11,70  |
| Q 16-8                               | 29,3 | 22,0 | 10,0 | 5,8 | 8,4  | M8         | 14,0 | 1,2 | 100 | 18,36  |
| Q 16-10                              | 31,9 | 24,0 | 10,0 | 5,8 | 10,5 | M10        | 18,0 | 1,2 | 100 | 15,85  |
| Q 16-12                              | 34,6 | 26,0 | 10,0 | 5,8 | 13,0 | M12        | 22,0 | 1,2 | 100 | 17,23  |
| Leiterquerschnitt 25 mm <sup>2</sup> |      |      |      |     |      |            |      |     |     |        |
| Q 25-5                               | 33,3 | 25,0 | 11,0 | 7,5 | 5,3  | M5         | 12,0 | 1,5 | 100 | 22,25  |
| Q 25-6                               | 33,3 | 25,0 | 11,0 | 7,5 | 6,5  | M6         | 12,0 | 1,5 | 100 | 25,92  |
| Q 25-8                               | 33,3 | 25,0 | 11,0 | 7,5 | 8,4  | M8         | 16,0 | 1,5 | 100 | 23,86  |
| Q 25-10                              | 34,6 | 26,0 | 11,0 | 7,5 | 10,5 | M10        | 18,0 | 1,5 | 100 | 28,33  |
| Q 25-12                              | 41,2 | 31,0 | 11,0 | 7,5 | 13,0 | M12        | 31,0 | 1,5 | 100 | 38,32  |
| Q 25-16                              | 47,9 | 36,0 | 11,0 | 7,5 | 17   | M16        | 35,0 | 1,5 | 100 | 38,60  |
| Leiterquerschnitt 35 mm <sup>2</sup> |      |      |      |     |      |            |      |     |     |        |
| Q 35-6                               | 34,6 | 26,0 | 12,0 | 9,0 | 6,5  | M6         | 15,0 | 1,6 | 100 | 32,13  |
| Q 35-8                               | 34,6 | 26,0 | 12,0 | 9,0 | 8,4  | M8         | 16,0 | 1,6 | 100 | 32,13  |
| Q 35-10                              | 35,9 | 27,0 | 12,0 | 9,0 | 10,5 | M10        | 18,0 | 1,6 | 100 | 34,05  |
| Q 35-12                              | 41,2 | 31,0 | 12,0 | 9,0 | 13,0 | M12        | 22,0 | 1,6 | 100 | 39,02  |
| Q 35-16                              | 47,9 | 36,0 | 12,0 | 9,0 | 17,0 | M16        | 28,0 | 1,6 | 100 | 41,54  |
| Leiterquerschnitt 50 mm <sup>2</sup> |      |      |      |     |      |            |      |     |     |        |
| Q 50-6                               | 45,2 | 34,0 | 16,0 | 4,5 | 4,3  | M6         | 18,0 | 1,8 | 100 | 47,46  |
| Q 50-8                               | 45,2 | 34,0 | 16,0 | 4,5 | 5,3  | M8         | 18,0 | 1,8 | 100 | 45,96  |
| Q 50-10                              | 45,2 | 34,0 | 16,0 | 4,5 | 6,5  | M10        | 18,0 | 1,8 | 100 | 45,96  |
| Q 50-12                              | 47,9 | 36,0 | 16,0 | 4,5 | 8,4  | M12        | 22,0 | 1,8 | 100 | 49,76  |
| Q 50-16                              | 53,2 | 40,0 | 16,0 | 4,5 | 10,5 | M16        | 28,0 | 1,8 | 100 | 65,68  |

Maßangaben ohne Gewähr, Richtwerte, Abweichungen möglich

# Ringkabelschuhe, unisoliert

- Kontaktmaterial Elektrolyt-Kupfer
- Oberfläche galvanisch verzinkt
- Abmessungen nach DIN 46234 oder ähnlich
- Temperaturbereich -60 bis +105°C
- maximale Betriebsspannung 600V

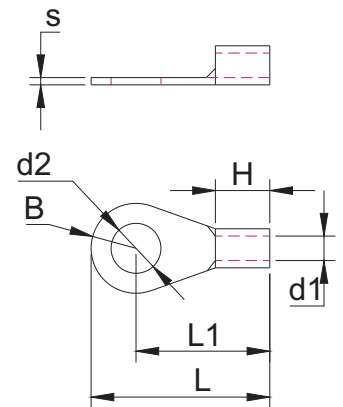

Weitere Querschnitte und Anschlussdurchmesser auf Anfrage

| Artikelnummer                         | L    | L1   | H    | d1   | d2   | für Bolzen | B    | s   | VE  | €/ 100 |
|---------------------------------------|------|------|------|------|------|------------|------|-----|-----|--------|
| Leiterquerschnitt 70 mm <sup>2</sup>  |      |      |      |      |      |            |      |     |     |        |
| Q 70-6                                | 50,5 | 38,0 | 18,0 | 13,0 | 6,5  | M6         | 22,0 | 2,0 | 100 | 65,34  |
| Q 70-8                                | 50,5 | 38,0 | 18,0 | 13,0 | 8,4  | M8         | 22,0 | 2,0 | 100 | 64,33  |
| Q 70-10                               | 50,5 | 38,0 | 18,0 | 13,0 | 10,5 | M10        | 22,0 | 2,0 | 100 | 64,23  |
| Q 70-12                               | 50,5 | 38,0 | 18,0 | 13,0 | 13,0 | M12        | 22,0 | 2,0 | 100 | 64,35  |
| Q 70-16                               | 55,9 | 42,0 | 18,0 | 13,0 | 17,0 | M16        | 28,0 | 2,0 | 100 | 80,75  |
| Leiterquerschnitt 95 mm <sup>2</sup>  |      |      |      |      |      |            |      |     |     |        |
| Q 95-8                                | 55,9 | 42,0 | 20,0 | 15,0 | 8,4  | M8         | 24,0 | 2,5 | 100 | 98,48  |
| Q 95-10                               | 55,9 | 42,0 | 20,0 | 15,0 | 10,5 | M10        | 24,0 | 2,5 | 100 | 98,48  |
| Q 95-12                               | 55,9 | 42,0 | 20,0 | 15,0 | 13,0 | M12        | 24,0 | 2,5 | 100 | 95,88  |
| Q 95-16                               | 58,5 | 44,0 | 20,0 | 15,0 | 17,0 | M16        | 28,0 | 2,5 | 100 | 123,35 |
| Leiterquerschnitt 120 mm <sup>2</sup> |      |      |      |      |      |            |      |     |     |        |
| Q 120-8                               | 58,5 | 44,0 | 22,0 | 17,0 | 8,4  | M8         | 24,0 | 3,0 | 50  | 150,20 |
| Q 120-10                              | 58,5 | 44,0 | 22,0 | 17,0 | 10,5 | M10        | 24,0 | 3,0 | 50  | 132,68 |
| Q 120-12                              | 58,5 | 44,0 | 22,0 | 17,0 | 13,0 | M12        | 24,0 | 3,0 | 50  | 132,68 |
| Q 120-16                              | 63,8 | 48,0 | 22,0 | 17,0 | 17,0 | M16        | 28,0 | 3,0 | 50  | 166,78 |
| Leiterquerschnitt 150 mm <sup>2</sup> |      |      |      |      |      |            |      |     |     |        |
| Q 150-10                              | 66,5 | 50,0 | 24,0 | 19,0 | 10,5 | M10        | 30,0 | 3,2 | 25  | 197,61 |
| Q 150-12                              | 66,5 | 50,0 | 24,0 | 19,0 | 13,0 | M12        | 30,0 | 3,2 | 25  | 197,61 |
| Q 150-16                              | 66,5 | 50,0 | 24,0 | 19,0 | 17,0 | M16        | 30,0 | 3,2 | 25  | 236,48 |
| Leiterquerschnitt 185 mm <sup>2</sup> |      |      |      |      |      |            |      |     |     |        |
| Q 185-10                              | 66,5 | 50,0 | 28,0 | 21,0 | 10,5 | M10        | 36,0 | 3,5 | 20  | 294,00 |
| Q 185-12                              | 66,5 | 50,0 | 28,0 | 21,0 | 13,0 | M12        | 36,0 | 3,5 | 20  | 296,55 |
| Q 185-16                              | 66,5 | 50,0 | 28,0 | 21,0 | 17,0 | M16        | 36,0 | 3,5 | 20  | 304,24 |

Maßangaben ohne Gewähr, Richtwerte, Abweichungen möglich

# Ringkabelschuhe, unisoliert

- Kontaktmaterial Elektrolyt-Kupfer
- Oberfläche galvanisch verzinkt
- Abmessungen nach DIN 46234 oder ähnlich
- Temperaturbereich -60 bis +105°C
- maximale Betriebsspannung 600V

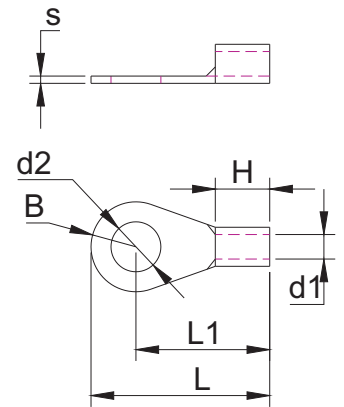

Weitere Querschnitte und Anschlussdurchmesser auf Anfrage

| Artikelnummer                         | L    | L1   | H    | d1   | d2   | für Bolzen | B    | s   | VE | €/ 100 |
|---------------------------------------|------|------|------|------|------|------------|------|-----|----|--------|
| Leiterquerschnitt 240 mm <sup>2</sup> |      |      |      |      |      |            |      |     |    |        |
| Q 240-10                              | 74,5 | 56,0 | 32,0 | 23,5 | 10,5 | M10        | 38,0 | 4,0 | 10 | 446,10 |
| Q 240-12                              | 74,5 | 56,0 | 32,0 | 23,5 | 13,0 | M12        | 38,0 | 4,0 | 10 | 451,24 |
| Q 240-16                              | 74,5 | 56,0 | 32,0 | 23,5 | 17,0 | M16        | 38,0 | 4,0 | 10 | 451,24 |

Maßangaben ohne Gewähr, Richtwerte, Abweichungen möglich